

Low Power Splitters

HPDL-xW-B-NF

- ◆ N Female Connectors
- ◆ 50 watt average power rating
- ◆ Low passive inter modulation (PIM)
- ◆ Superior isolation to reactive power splitters
- ◆ Minimal RF insertion loss
- ◆ Easily wall mounted
- ◆ High reliability

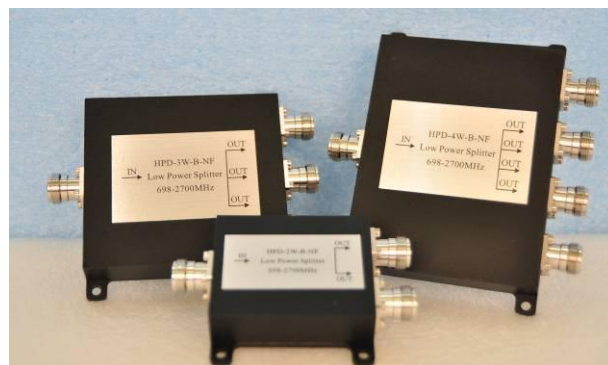

	HPDL-2W-B-NF	HPDL-3W-B-NF	HPDL-4W-B-NF
No. of Ways	2	3	4
Freq. Range (MHz)	698—2700		
VSWR	1.2:1	1.25:1	1.3:1
Split Loss (dB nom.)	3.0	4.8	6.0
Insertion Loss (dB max.)	0.4	0.6	0.6
Isolation (dB min.)	20	20	698-800:18 800-2500:20 2500-2700:18
Power Rating (watts)	Splitting: 50 / Combining: 0.5		
PIM (dBc) *	-150		
Impedance (Ω nom.)	50		
Temperature Range (C)	-25° to +85°		
Relative Humidity (%)	0 to 100		
Applications	Indoor / Outdoor, IP65 rating		
Connectors	N Female		
Connector Finish	Inner layer—Silver plate / Outer layer—Cu-Sn-Zn plate		
Housing Finish	Black powder paint		
Weight, g (lb)	260 (0.57)	540 (1.19)	650 (1.43)

* : PIM 3rd order dBc @ 2x 43 dBm

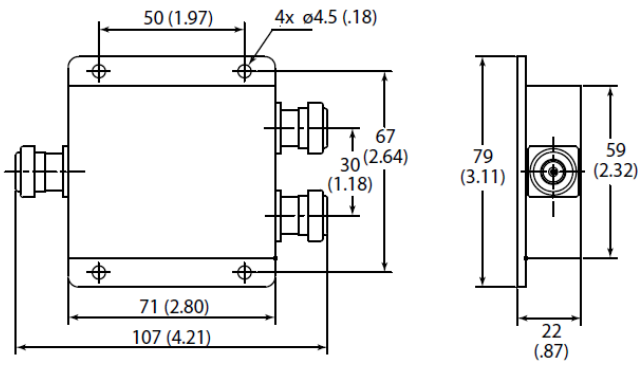

HPDL-2W-B-NF

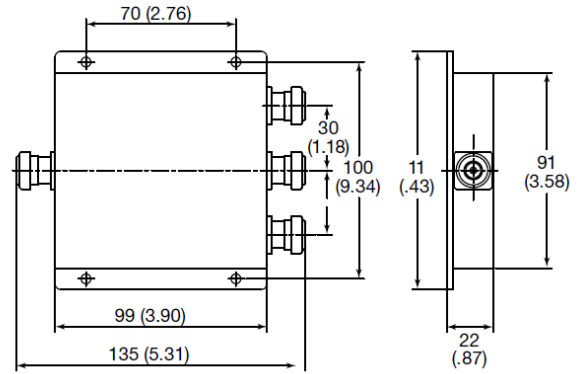

HPDL-3W-B-NF

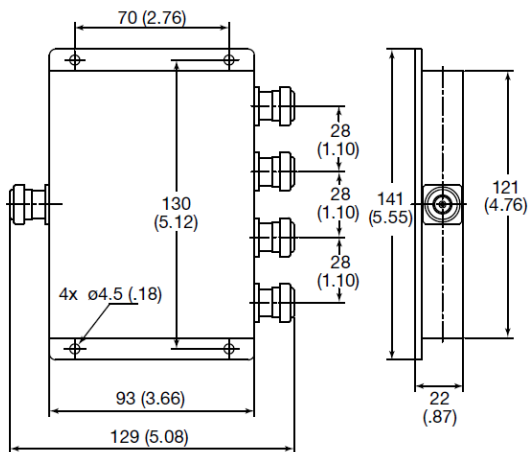

HPDL-4W-B-NF

